

Stonebridge Park

EASTVILLE

APPROXIMATE FLOOR AREA
101 SQM / 1091 SQFT



Ground Floor

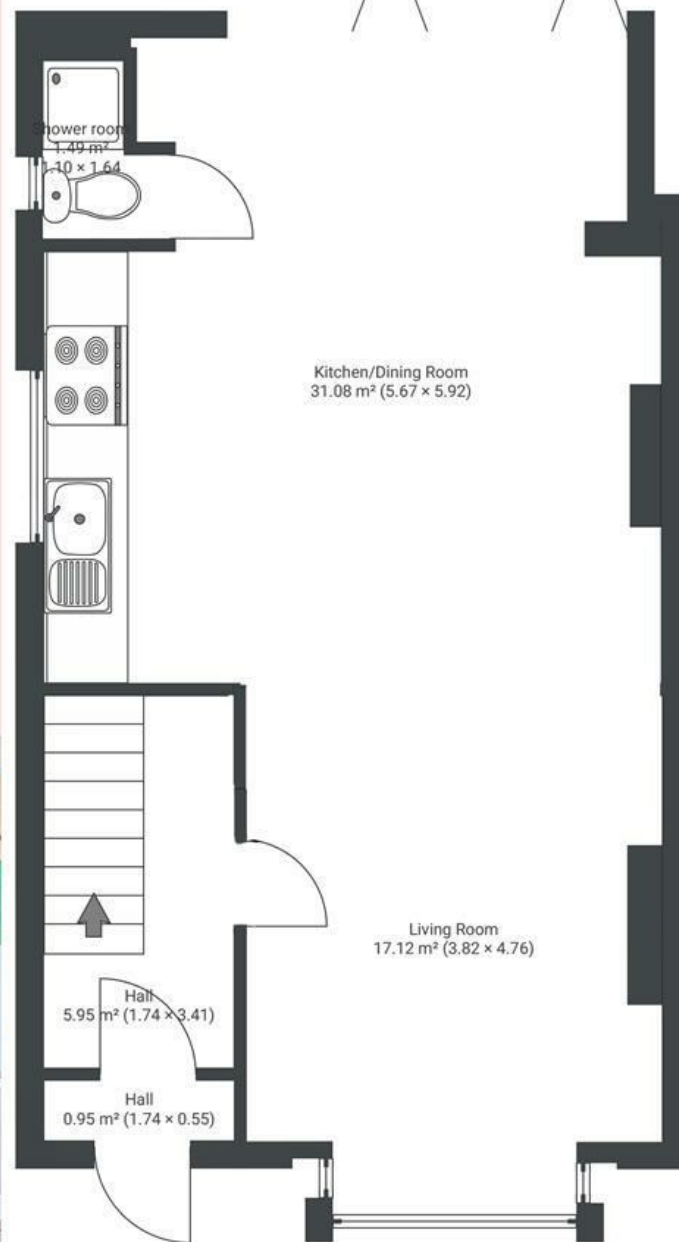

1st Floor

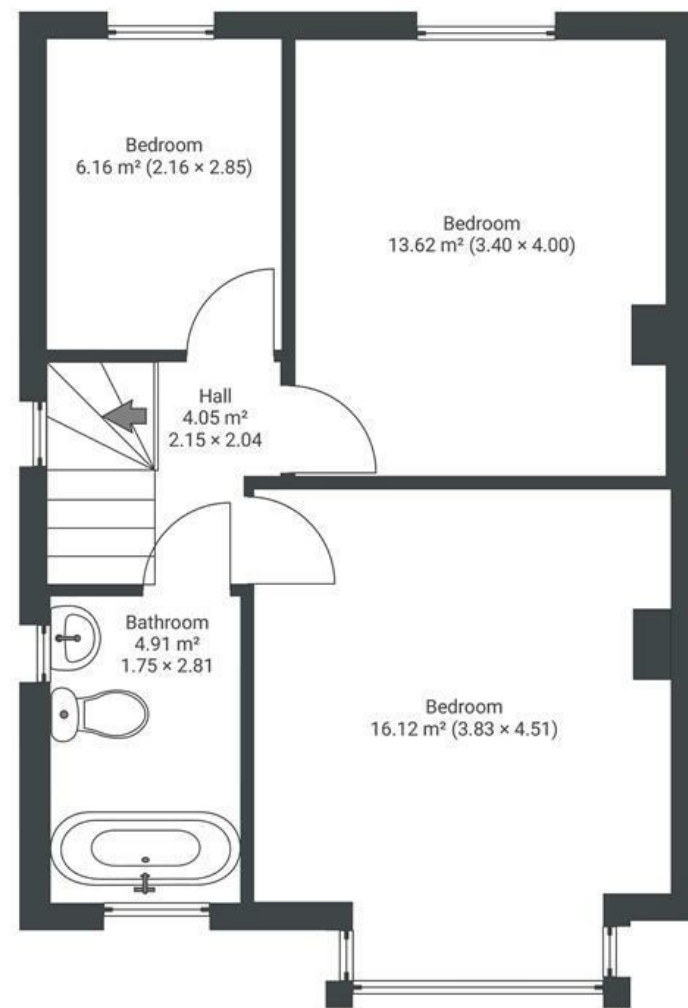

~~Boardwalk~~

Stonebridge

EASTVILLE, BRISTOL



£525,000



Bristol, BS5

6RW



3 Bedrooms



2 Bathrooms

"We spent nine fun-filled years converting this house into our "forever Eco-Home", welcoming our daughter in Jan 2022. During our time here we had street parties, Christmas drinks together, shared birthday parties, nights out, and were spoilt by the amazing cooking and cake baking of many of our neighbours! Our daughter loved going down to the river early morning to spot the otters, fishing herons or hummingbirds, and paddle on hot days.

We built our home to be the healthiest, cosiest, most peaceful home we could for our little one. As such, the paints and carpets are natural e.g., undyed 100% wool, there is whole house insulation (under floor, cavity wall, loft and air-tightness) combined with Honeywell EvoHome zoned heating control and demand-led ventilation to ensure fresh air whilst wasting minimal heat. The triple glazing means a near silent house whatever's happening outside. On efficiency, there are solar panels, rainwater harvesting, LED lighting throughout, and Electric Vehicle fast-charging. All this means drastically reduced bills, alongside annual income from the solar panels."

